

Senise Destiny 116 Super Yacht

Senise Destiny is a new concept in luxury Super Motor Yachts designed for the discerning elite. The first vessel planned is the 116 meter Senise Destiny 116. This concept model will also be available in other sizes, 65 meters, 80 meters and the Senise Destiny143, a Luxury Mega Yacht of 143 meters.

The Senise Destiny Super Yacht is developed together with some of the world's most distinguished firms in the field of marine design, construction and technology. Only the finest qualities in design and construction technologies, with environmental sustainability in mind, are employed in the Senise Destiny concept.

A unique feature of the Senise Destiny yachts is the globe shaped superstructure, a hallmark of Senise design. The dome transcends the three upper decks, with an extraordinary VIP suite on its upper level.

In addition to the VIP suite, accommodation aboard comprises an exceptional owner's suite and twelve spacious and luxurious guest suites. Each suite has its own communication and digital entertainment facilities. There are also quarters for the accommodation of up to forty crew members.

Dimensions

The principal dimensions are:

L o a 116 meters

B o a 20 meters

Accommodation

The Senise Destiny 116 includes accommodation in:

- 1 Owner suite
- 1 VIP suite
- 12 Guest suites
- 7 Officer cabins
- 24 Double crew cabins

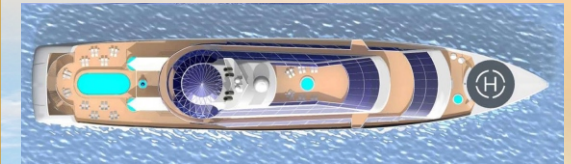

**SENISE
MARITIME**



Senise Destiny 116 Super Yacht

Cruising comfortably at 18 knots, this ocean-going vessel with long-range capabilities enable owners and their guests to enjoy both sophisticated ports and tranquil hideaways.

Important technical features of the yacht will be the latest state-of-the-art navigational equipment and Polar Ice classification allowing the vessel to cruise virtually anywhere in the world, including, the Arctic Region with the North-west Passage. This is not currently available on any other comparable Super Yacht.

There is a helipad located on the foredeck. After landing on the helipad the helicopter can be lowered into its hangar with the help of internal lifting devices between decks.



The yacht's tenders are stowed below aft in a full-beam tender bay, which also accommodates a submarine, speed boats, jet skis, crafts, ribs and all equipment for diving, snorkelling, and other water sports. An overhead crane is available to launch the submarine, each of the two tenders and two speedboats through port and starboard hull doors, thus preserving the yacht's stern for boarding.

SENISE MARITIME



Senise Destiny 116 Super Yacht

Onboard facilities include restaurant, lounge, swimming pool, Jacuzzis, beauty salon, full spa facilities with therapy rooms, cinema, car garage and the latest in communications and digital entertainment amenities.

Public Spaces

- Beauty salon
- Spa
- Therapy room
- Cinema
- Restaurant
- Lounge
- Tender boats,
- Jet skis,
- Ribs,
- Submarine,
- Swimming pools,
- Jacuzzis
- Car garage
- Helipad with hangar for helicopter

Guest Suites

- Bathroom
- Living room
- Walk-in closet



Owner Suite

- Private sun pit with two hot tubs
- Two guest cabins
- Dining room
- Living room
- Office
- Grand size bed with ocean view

VIP Suite

- Private balcony aft
- Grand sun pit with hot tub
- His and her bathroom
- Dining table for 10 guests
- Dedicated pantry
- Grand size bed with ocean view

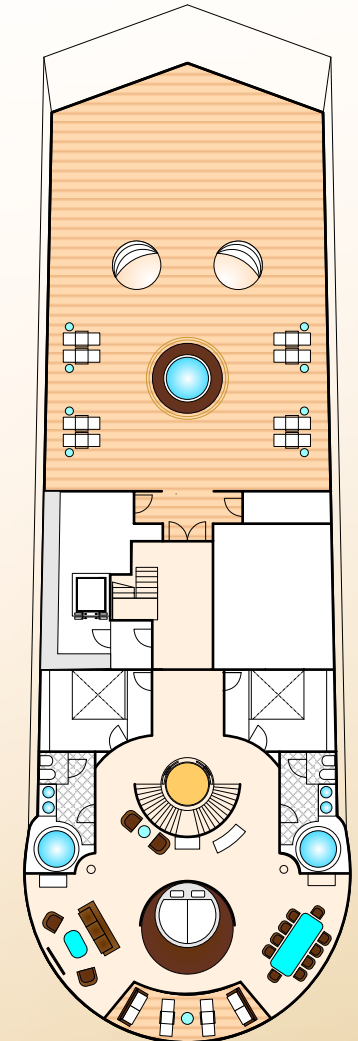
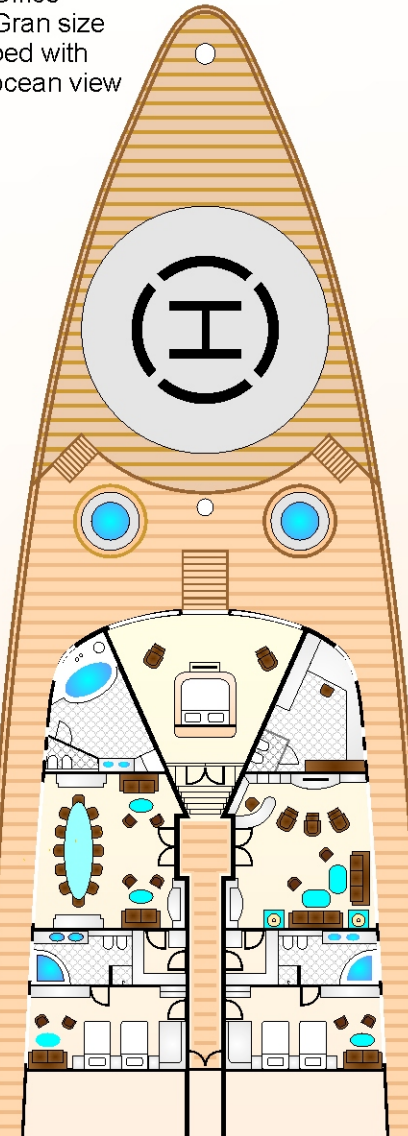

SENISE MARITIME